



Statement

The CP-21 series call point, with double pole change over contacts from N/C to N/O. The main function is to override the electrical locking/release devices in case of emergency. With Key to replace glass.

Specifications

Dimensions: 88x88x52 mm
 Contact resistance: 150mΩ
 Switch rating: 3A/125VAC

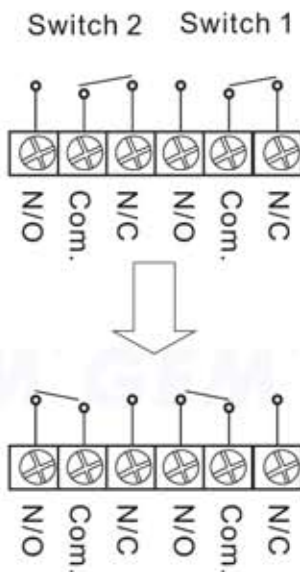

Application

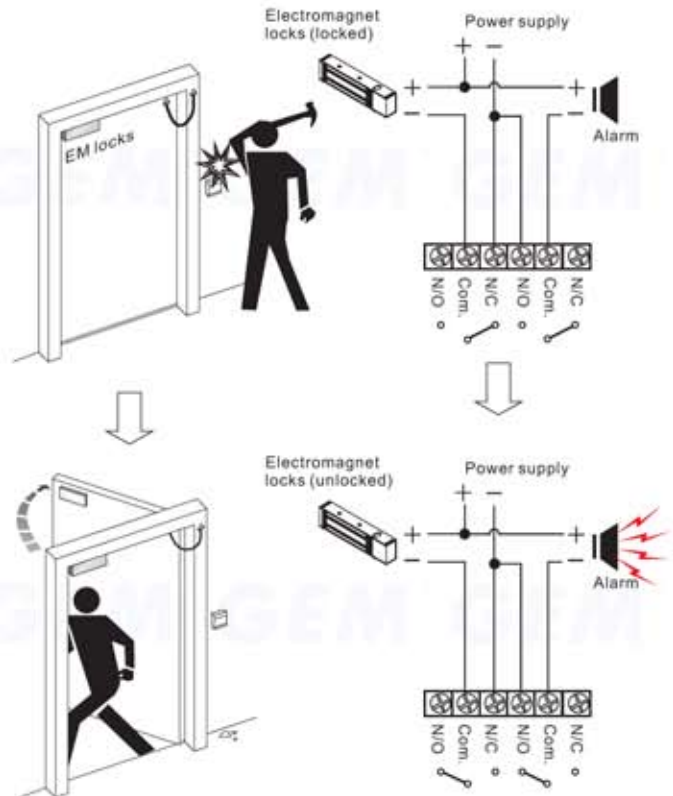

Dimension

(European Size)

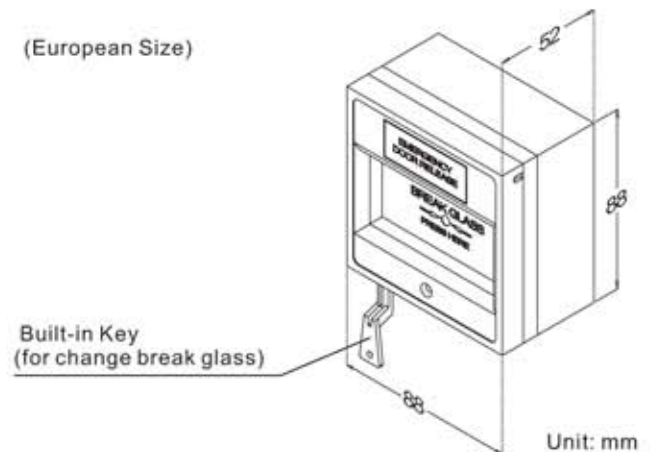

Warranty

The product is warranted against defects in material and workmanship while used in normal service for a period of 1 year from the date of sale to the original client. The GEM policy is one of continual development and improvement; therefore GEM reserves the right to change specifications without notice.



Statement

The CP-22 series call point, with double pole change over contacts from N/C to N/O. The main function is to override the electrical locking/release devices in case of emergency. With Key to reset unit.

Specifications

Dimensions: 88x88x60 mm
 Contact resistance: 150mΩ
 Switch rating: 3A/ 125VAC

Application

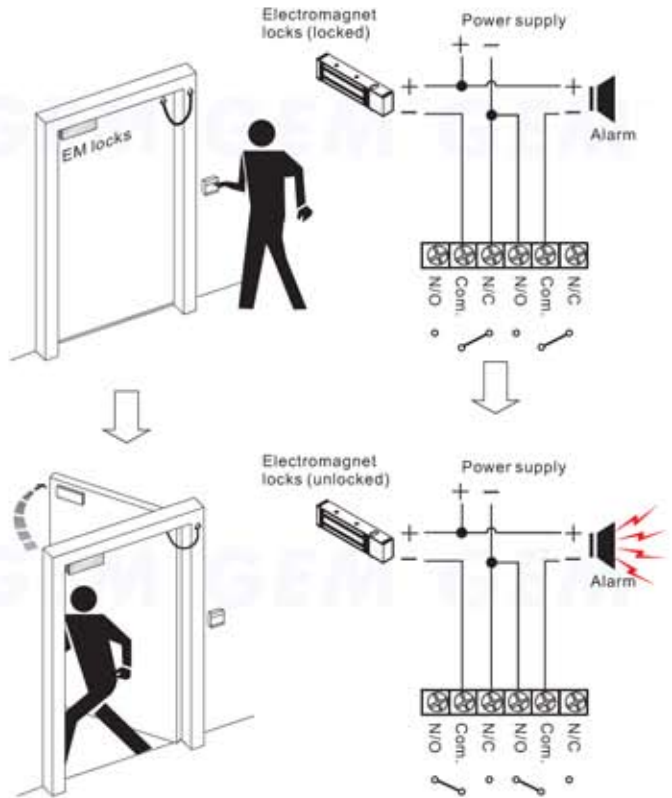

Dimension

Unit: mm
 (Common Europe Sized)

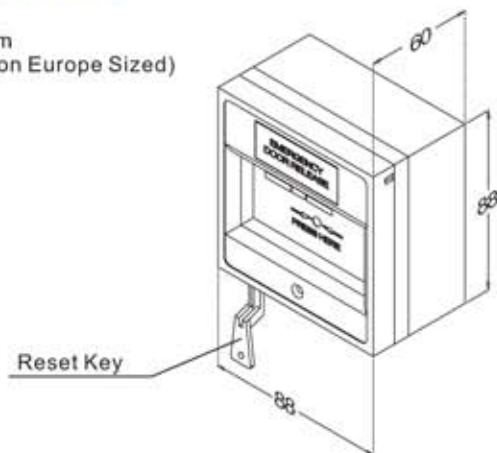

Warranty

The product is warranted against defects in material and workmanship while used in normal service for a period of 1 year from the date of sale to the original client. The GEM policy is one of continual development and improvement; therefore GEM reserves the right to change specifications without notice.

